

Map to the 2015 Annual Ordinary General Meeting of Shareholders  
of TTW Public Company Limited

30<sup>th</sup> March 2015 Landmark Ballroom, 7<sup>th</sup> Fl., Landmark Hotel Bangkok  
138, Sukhumvit Road, Klongtoey, Bangkok Tel : 0-2245-0404

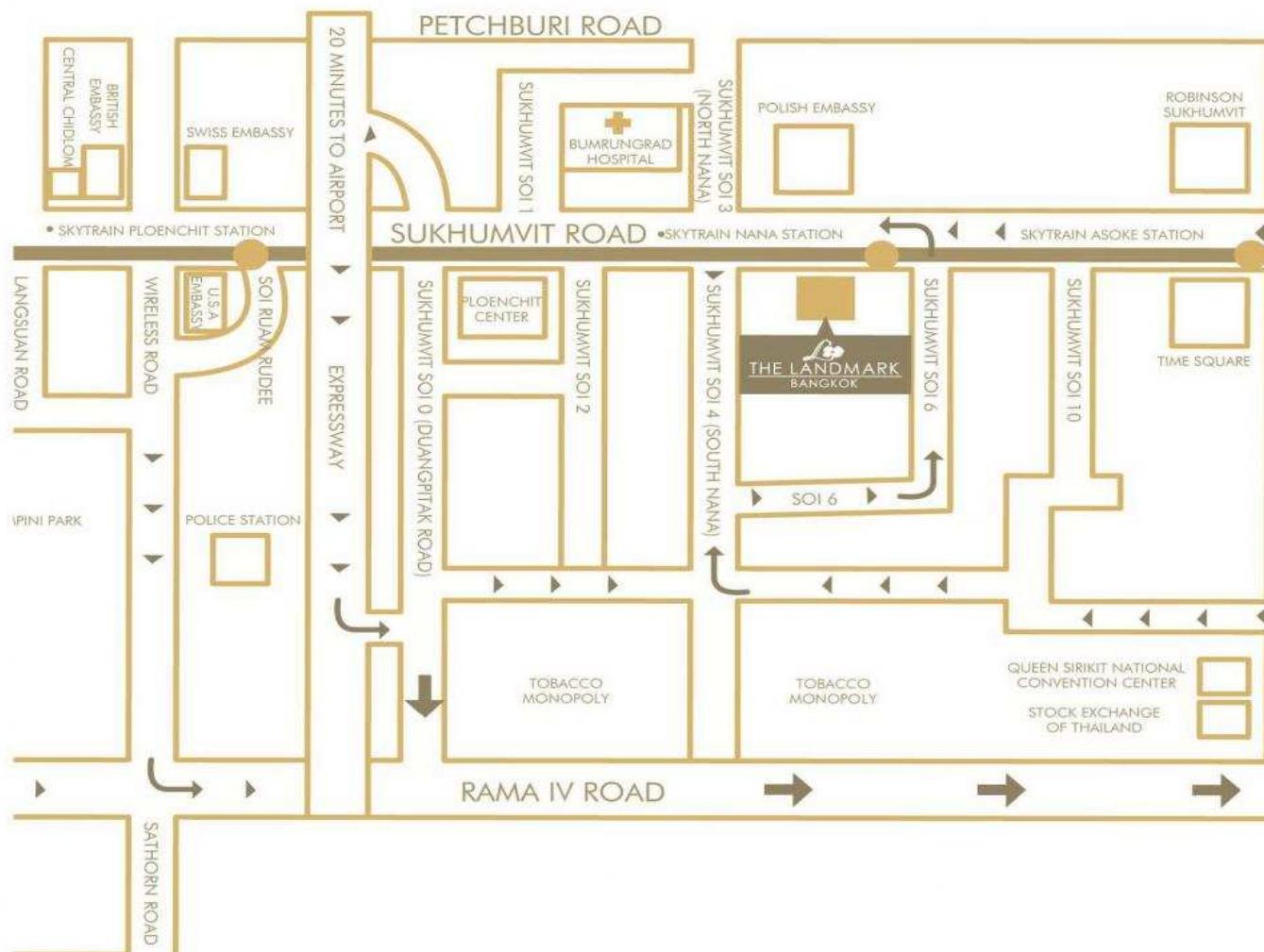

## LANDMARK BANGKOK HOTEL MAP

138 Sukhumvit Road. Bangkok 10110. Thailand  
Tel: 66 (0) 2254 0404 Fax: 66 (0) 2253 4259

### Bus Route

2, 25, 38, 40, 48, 98, 501, 511 and 513

### BTS Skytrain

Nana Station E2